

# Information Sheet for 'COM Monitor'

## Diagram:

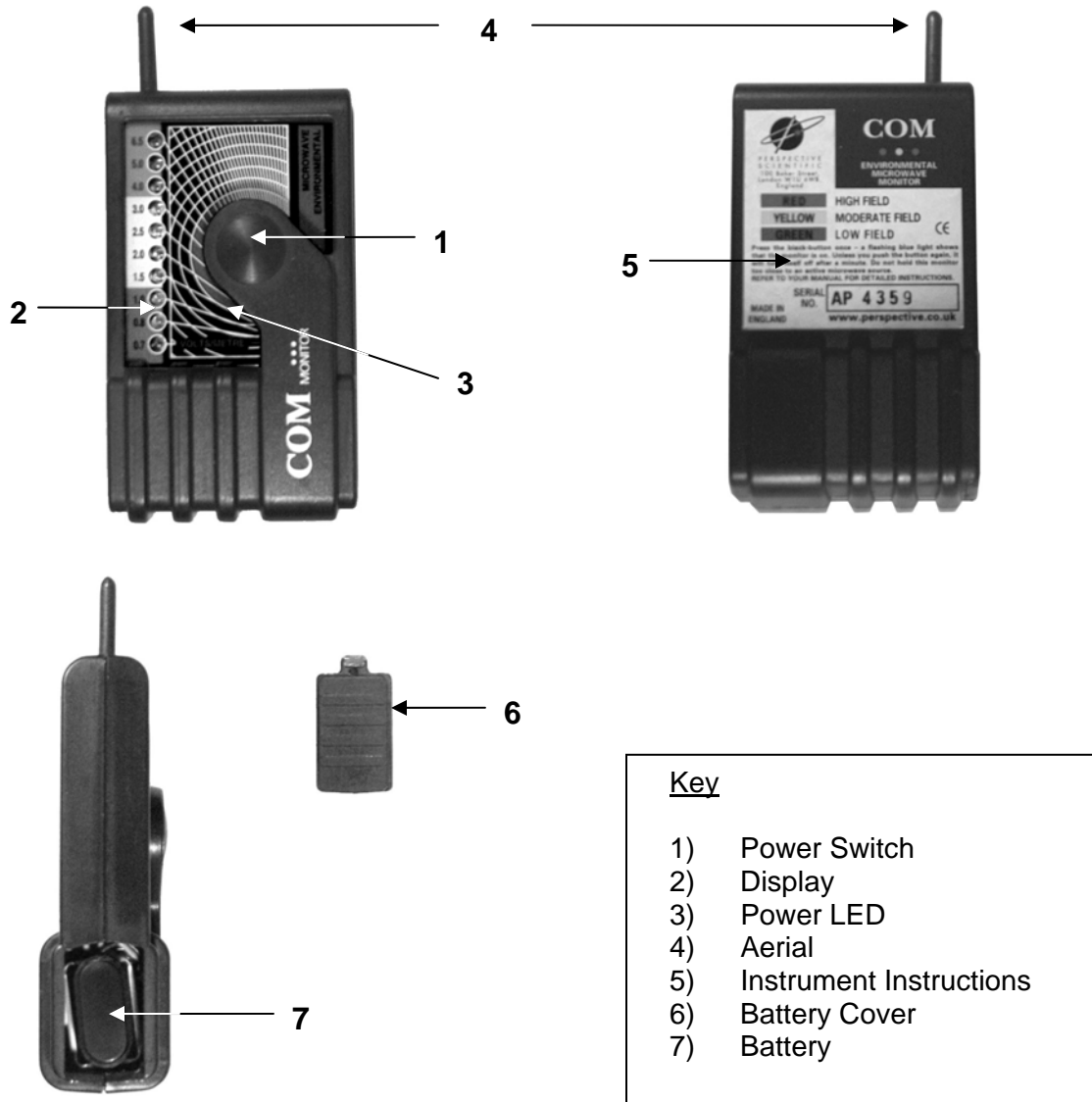

| <u>Key</u> |                         |
|------------|-------------------------|
| 1)         | Power Switch            |
| 2)         | Display                 |
| 3)         | Power LED               |
| 4)         | Aerial                  |
| 5)         | Instrument Instructions |
| 6)         | Battery Cover           |
| 7)         | Battery                 |

## Instructions for Use:

- 1) Check battery is correctly inserted and press "on" button
- 2) Hold in one hand at about 1 foot from your body with the display towards you. Do not put your hand over the aerial.
- 3) Watch display for any readings
- 4) The COM has a timer that will automatically cause it to turn itself off after approximately 1 minute – to reset the timer, press the "on" button again

## **Troubleshooting:**

| <b>Problem</b>  | <b>Possible Solutions</b>  |
|---|--|
| The COM doesn't seem to be working<br>The COM is not showing any reading                                  | <ul style="list-style-type: none"><li>• Check that the 'on' button has been pressed.</li><li>• Check that the battery is correctly inserted into the instrument.</li><li>• The battery may be flat. Try changing it.</li><li>• If the instrument has a blue flashing light every few seconds, then it is turned on and working</li></ul> |
| I get a high reading when it is turned on, and again when it goes off, but cannot find it at other times. | <ul style="list-style-type: none"><li>• The display will momentarily flash a high reading when the COM is turned on and again when it turns off, this is completely normal.</li><li>• If there is a genuine high reading, you should be able to consistently find it</li></ul>   |
| The instrument is not picking up signals very well<br>The instrument does not seem sensitive enough       | <ul style="list-style-type: none"><li>• Make sure that you are pointing the aerial towards the source</li><li>• The source may be too far away</li><li>• Make sure your fingers do not cover the aerial</li></ul>  |
| The instrument is giving varying readings   | <ul style="list-style-type: none"><li>• Make sure your fingers are not covering the aerial</li><li>• The source may be varying in power – the instrument is sensitive</li><li>• Make sure you hold the instrument very still, or place it on something to hold it steady.</li></ul>  |
| The instrument keeps turning off  | <ul style="list-style-type: none"><li>• This is intentional, it is to preserve battery life. Simply press the button again to switch the COM on again.</li></ul>   |

## **Technical Specifications:**

Frequency response range: 250 MHz – 2500 MHz

Detection Range: 0.7 to 6.5 Volts per metre [V/m]

Scale Points: 0.7, 0.8, 1, 1.5, 2, 2.5, 3, 4, 5, 6.5 V/m

Power Draw: 15-38 mA      Power Source: 9v PP3

Battery Life: 20 hours

Size: 29mm x 58mm x 98mm + 21mm (LxWxH+Aerial)

Weight: 110g

## **Guarantee**

The COM comes with a 2 year RTB (return to base) Manufacturer's Guarantee, subject to arrangement. Please contact us for details. It is guaranteed to be free of manufacturing defects, but not against wear from normal use.

## **Note**



The Waste Electrical and Electronic Equipment (WEEE) Directive (2002/96/EC) requires that old and unwanted electronic equipment must be disposed of using appropriate recycling and not placed in your dustbin or with your normal domestic waste. When you no longer require your electronic instrument, you can return it to us for recycling. Your postage will be refunded. Some UK local waste recycling centres will also provide collection points for electronic instrument recycling under the WEEE regulations.